

Céliane™ RDS tuner with LCD screen

Catalogue number(s): 673 26

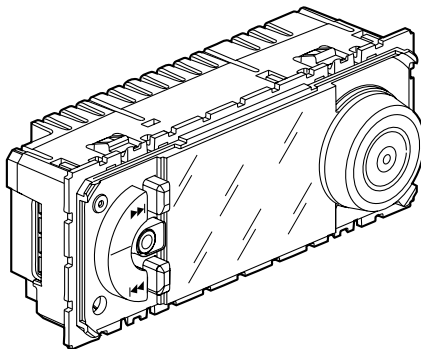

1. GENERAL FEATURES

- 1-zone sound distribution: for installation in Batibox flush-mounting box, 50 mm depth recommended.
- Built-in 230 V power supply.
- Manual or automatic station selection (RDS search). Stores 2x9 stations.
- Built-in aerial.
- Volume, balance, bass/treble and loudness control.
- Has an auxiliary input (3.5 mm diameter jack) for connecting an MP3 player (lead not supplied).
- Compatible with 4/8 or 16 ohm loudspeaker, with stereo or mono output.
- Loudspeaker power 2 x 3 W.
- Station display, creation of 2 favourites lists (2x9 memories).
- Alarm function (possible to set 2 different times), with selection of loudspeaker (left or right) for each alarm.
- Timer function.
- On/off control (manual/automatic), presence of mains supply.
- For use with a 4/5 module plate and support 802 52.

2. RANGES

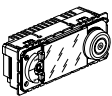
	Description	Cat. No.	Number of modules	Connection method	Weight (g)
	RDS tuner	673 26	5	screw	112

3. POSITIONING

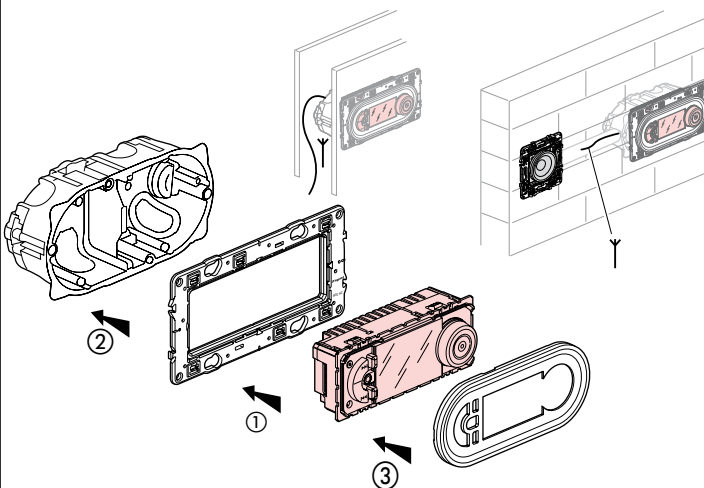

- 1 - Clip the rear of the mechanism onto the support
- 2 - Screw the mechanism/support assembly onto the flush-mounting box
- 3 - Clip the rocker plate then the ring onto the mechanism

4. OVERALL DIMENSIONS

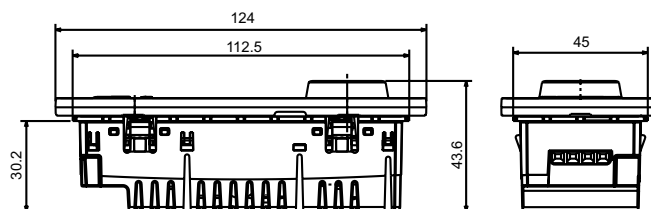

5. CONNECTION

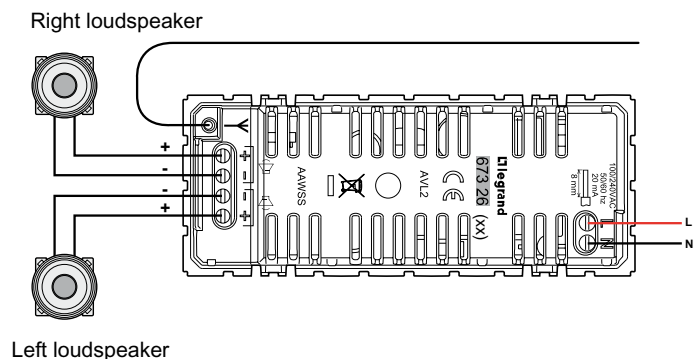

Number of terminals: 4 for loudspeaker (1.5 mm²)/2 for mains supply (4 mm²).
 Type of terminals: screw
 Stripping length: 6 mm
 Tool: 3.5 mm flat screwdriver
 Distance 10 m maximum between the tuner and the loudspeaker with 1 mm² wire

6. TECHNICAL FEATURES

6.1 Mechanical features

Impact resistance: IK 04
 Penetration by solid/liquid matter: IP 41 (C15-100)

6.2 Materials

Polycarbonate

6.3 Electrical features

Self-extinguishing: 650°C/30 s
 Voltage: 230 VAC
 Frequency: 50/60 Hz
 Consumption at 220 V:
 Off-load: 2 W/h
 On-load: 4 W/h

6.4 Climatic features

Storage temperature: - 10°C to + 60°C
 Usage temperature: - 5°C to + 50°C

7. MAINTENANCE

Maintenance-free

8. COMPLIANCE AND APPROVALS

EN 55013/A1/A2
 EN 55020
 EN 61000-3-3/A1/A2

9. ACCESSORIES

	Description	Cat. No.	Mounting	Features
	2" wall-mounting loudspeaker	673 28	For installation in flush-mounting boxes	2 W - 16 ohms
	2" loudspeaker (ø 80 mm) Spot type	673 27	Blades Springs	2 W - 16 ohms White
	6.5" standard flush-mounting loudspeaker	673 29	Flush-mounting	100 W - 8 ohms White
	Invisible loudspeaker (ø 98 mm)	673 30	Adhesive Lugs Partition (supplied with the fixing accessories)	8 W - 8 ohms
	Loudspeaker socket	673 11	Clips/screws	For connecting loudspeakers with any impedance